

Romania has an almost round geographical form covering a surface of 238,391-sq. km and it is situated mid-way between the Equator and the North Pole



Romania country profile

1. Area:	237,500 sq. km.
2. Arable as % of total land:	41
3. Capital:	Bucharest
4. Population:	22.3 m.
5. Population per sq. km.:	93.9
6. Urban population:	54.7%

The Romanian heights complete the panorama of European scenery



The “Ceahlau” mountains



Bran Castle built in the early 13th Century



Corvin Castle built in the 13th Century



Peles Castle built by King Carol I



People from Maramures – North part of Romania



Church of Voronet Monastery, a monument with fabulous paintings well known in the world as “Voronet blue”



Sibiu – European Capital of Culture 2007



Bucharest – University Square



The Black Sea Coast



Water lilies in the Danube Delta

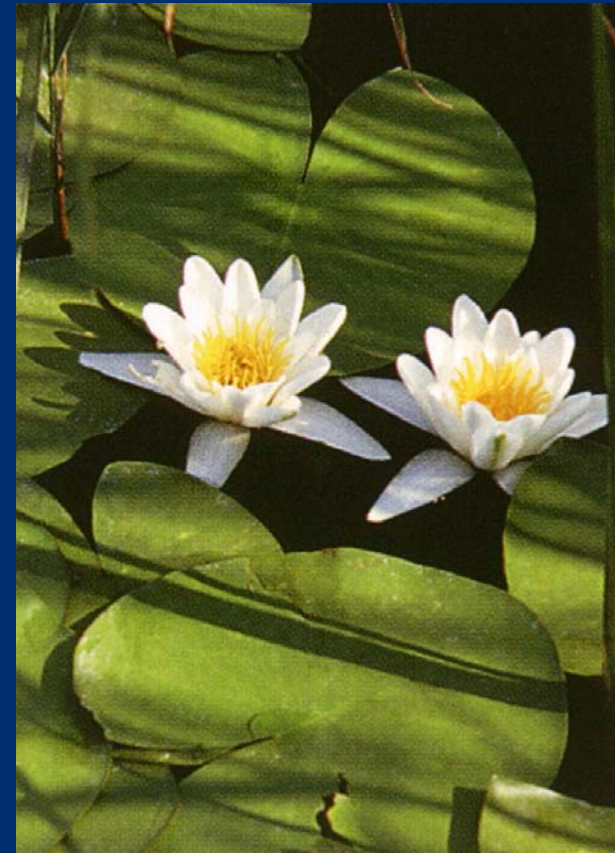

Galati City is located in the east part of Romania, on the left bank of the Danube 80 miles from the Black Sea

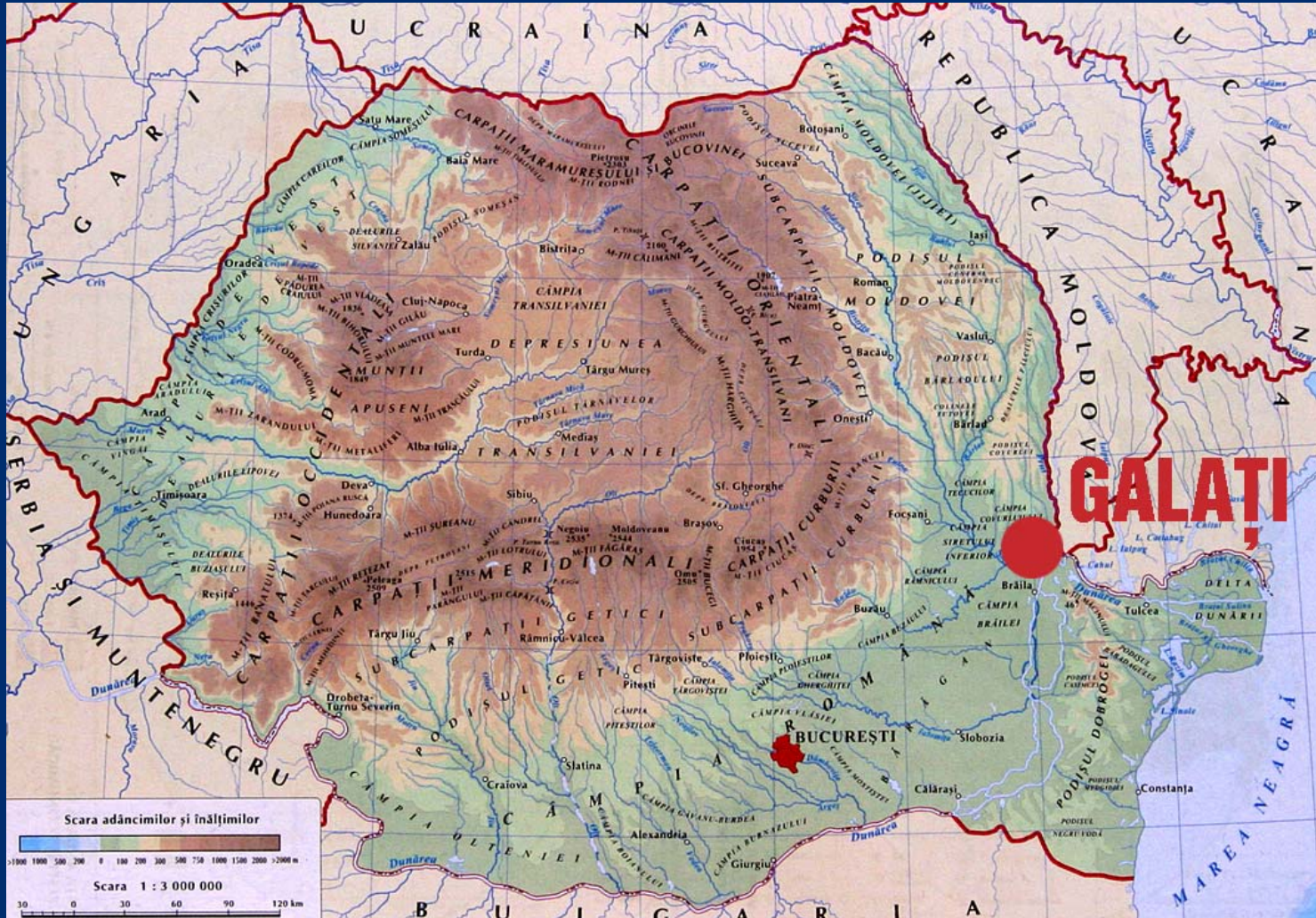

Galati City



The Administrative Palace



The “Fani Tardini” Theatre



The Navigation Palace - 1912



The “Dunarea de Jos” University



The Danube bank



Damen Shipyards Galati



Welcome!



Continuous improvement

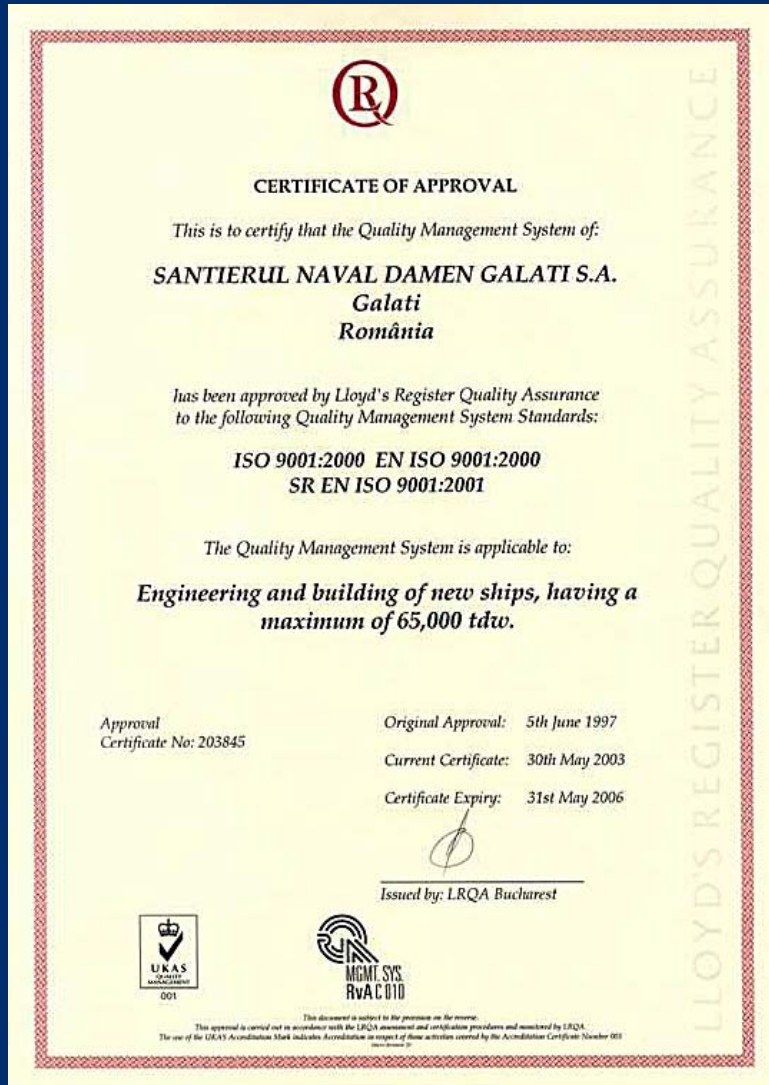

We continuously control and upgrade our customer-focused process.

The two most important parameters to become “The preferred shipbuilder” are:

- To build confidence
- To be price and costs competitive

Damen Shipyards Galati

**Damen Shipyards Galati is a member of
Damen Shipyards Group**



Facts & Figures 2007

Damen Shipyards Galati

Turnover: 71 mill. Euro

Employees: 3,100

Annual deliveries: 24 units

World wide export to 29 countries: 100%

Production Facilities – Yard Map



Production line 1

Vessels up to 10,000 dwt.

1. **Cutting capacity: 1,800 tons/month;**
2. **Section building capacity: 1,800 tons/month;**
3. **One building berth: length x breadth: 210.0 m x 21.0 m;**
4. **Maximum dimensions of vessels: 145 m x 21 m x 4.5 m;**
5. **Maximum weight of vessels before launching: 4,000 tons;**
6. **Type of vessels built on line 1:**
 - **Container Feeders 800TEU;**
 - **Chemical/Oil Tankers;**
 - **Combifreighters; Minibulkers;**
 - **Cargo Vessels;**
 - **Barges;**
 - **Tugs & Workboats.**

Production line 1



Production line 1



Production lines 2 and 3

Vessels up to 26,000 dwt. (line 2) & Vessels up to 50,000 dwt. (line 3)

- 1. Cutting capacity: 2,200 tons/month;**
- 2. Section building capacity: 2,500 tons/month;**
- 3. Two building berths (line 2): 180.0 m x 25.0 m (length x breadth);**
- 4. One dock (line 3):**
 - one dry room of 235.0 m x 34.8 m x 4.5 m;**
 - one wet room of 240.7 m x 34.8 m x 5.0 m;**
- 5. Maximum dimensions of vessels:**
 - 150 m x 25 m x 5 m (line 2);**
 - 200 m x 32 m x 4.5 m (line3);**
- 6. Maximum weight of vessels before launching (line 2): 6,000 tons;**
- 7. Type of vessels built on line 2:**
 - Container Feeder 800TEU; Tank barges;**
 - Ro-Ro Ferry; Tugs and Workboats;**
- 8. Type of vessels built on line 3:**
 - Container Feeders 800TEU;**
 - Heavy Lift Vessels;**
 - AWS Pilot Structure and Specials.**

Production lines 2 and 3

Esab Plasma Cutting Machine



Bending Machine



Production lines 2 and 3

Profile line



Production lines 2 and 3



Production lines 2 and 3



Production lines 2 and 3



Production lines 2 and 3



Production line 4

Tugs and Workboats

1. **10 halls for inside complete vessels construction:**
 - 5 halls of: 34.0 m x 15.5 m;
 - 5 halls of: 34.0 m x 12.5 m;
2. **Maximum dimensions of vessels:**
 - LxBxH = 29 m x 12 m x 14 m;
 - LxBxH = 29 m x 9 m x 14 m;
3. **Maximum weight of vessels: 300 tons;**
4. **Type of vessels to be built on line 4:**
 - ASD Tugs;
 - STAN Tugs.

Production line 4



Production line 4



Production line 5

Nozzles

1. Capacity: 100 units/year;
2. Maximum dimensions of nozzles: diam.3,636 mm x 1,800 mm;
3. Maximum weight of nozzles: 16,500 kg;
4. Two manipulators;
5. Type of nozzles:
 - Optima;
 - HR;
 - Schottel.

Production line 5



Piping & Deep Hot Galvanizing Workshop

A. Piping - prefabricating of:

1. Black pipes;
2. CuNiFe pipes;
3. Stainless steel pipes;
4. Fiber glass pipes.

B. Deep Hot Galvanizing Workshop:

Deep hot galvanizing process;

Max. dimensions: 1,320 mm x 1,320 mm x 6,000 mm.

Piping Workshop



Deep Hot Galvanizing Workshop



Painting Halls



Engineering Department

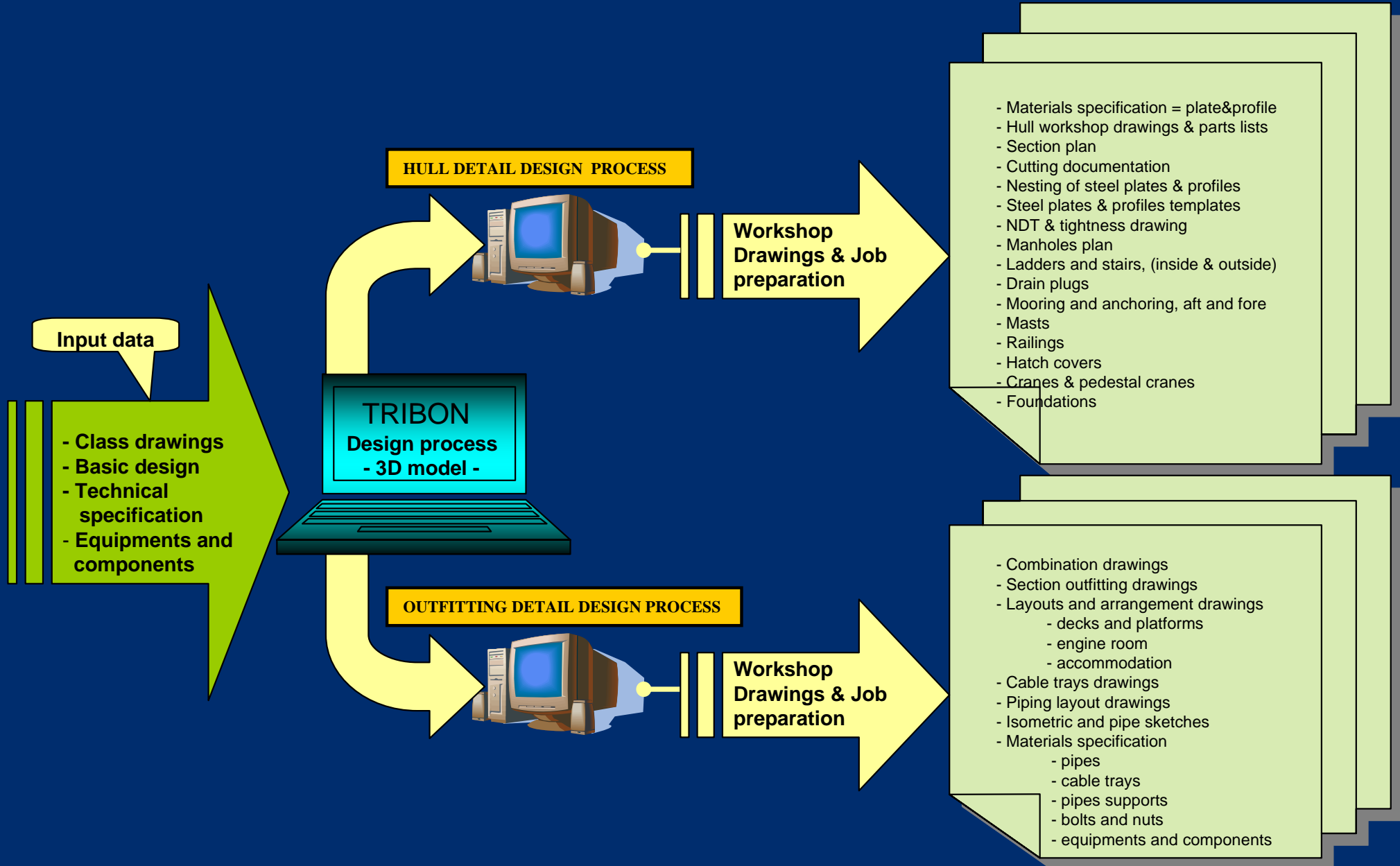

Engineering Department - Tribon Modeling

Combi Feeder 800 TEU

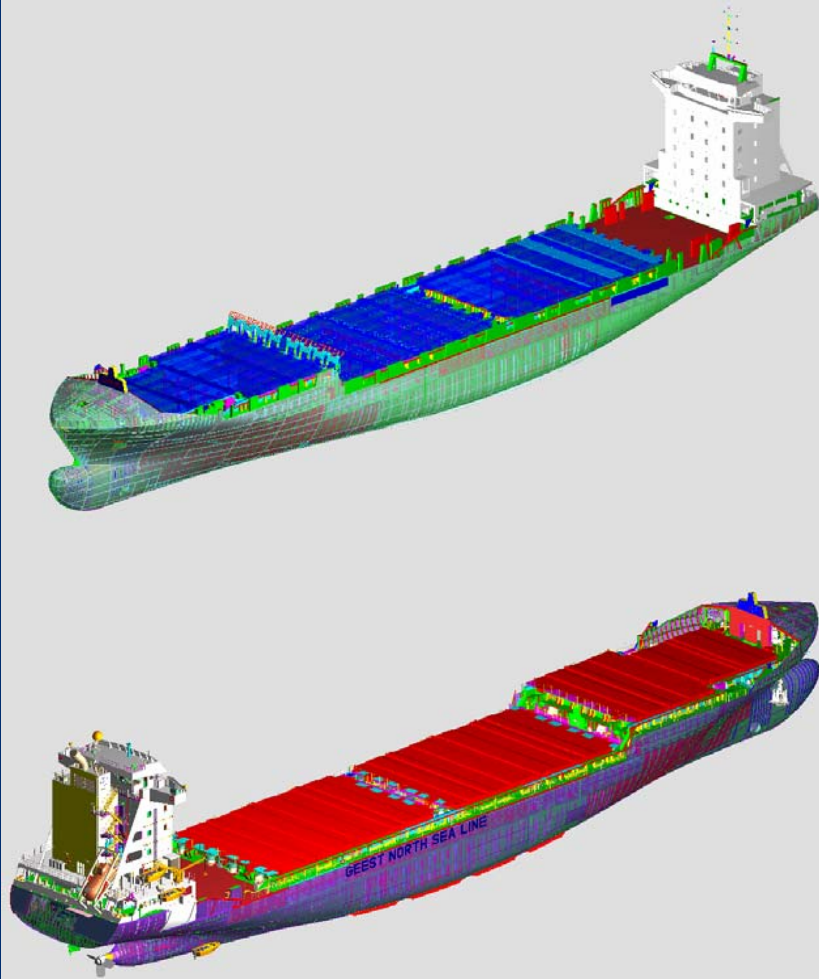

Safety Chemical Oil Tanker 8,150 dwt.

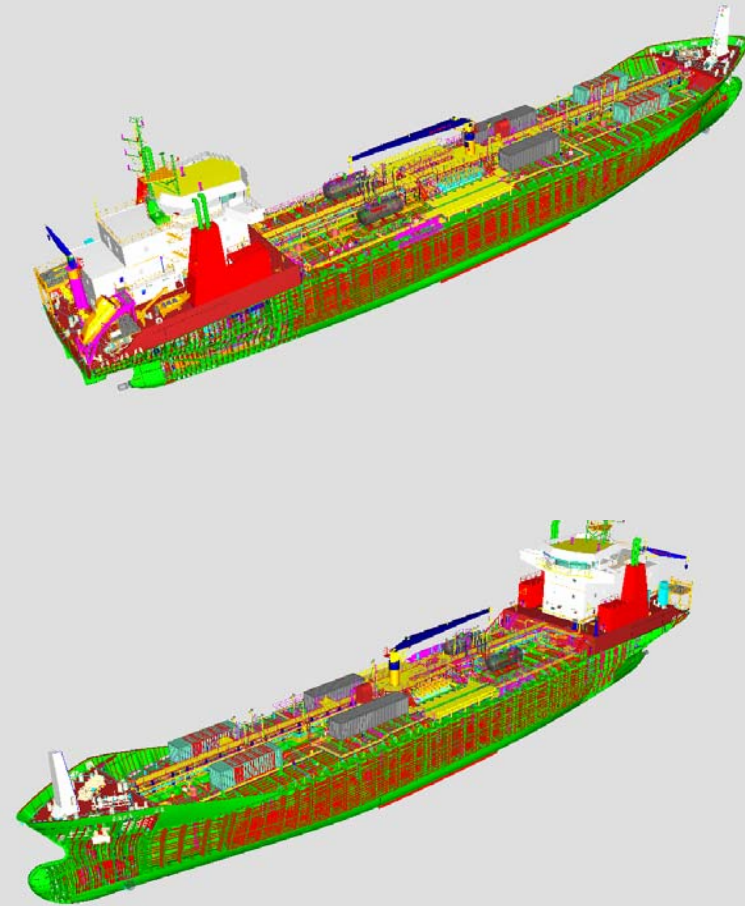

Engineering Department - Tribon Modeling

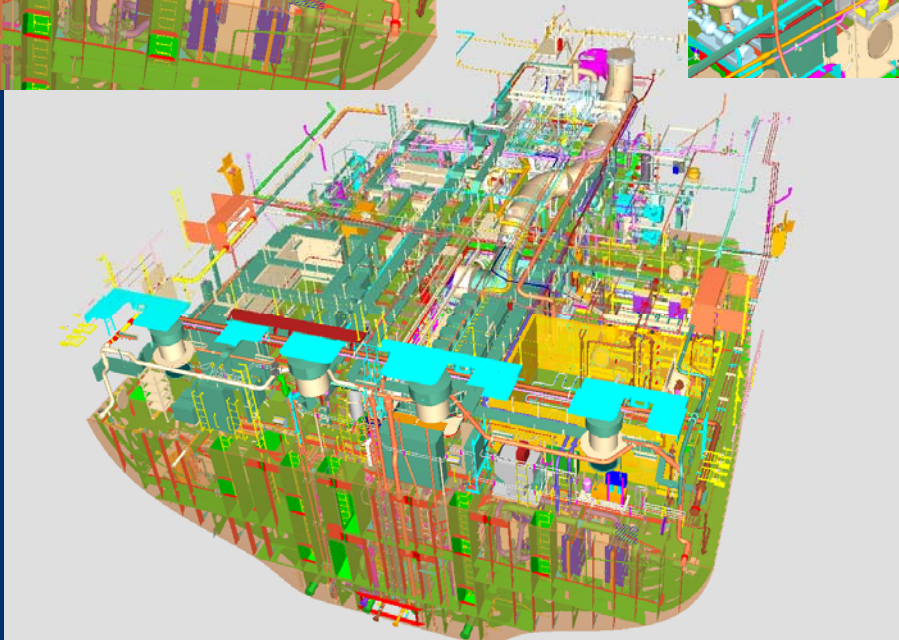
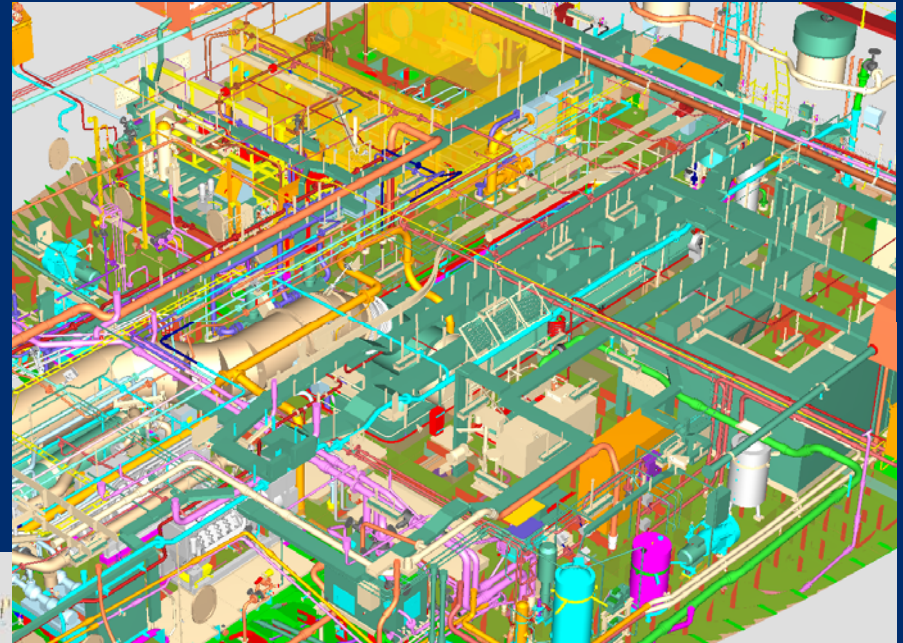
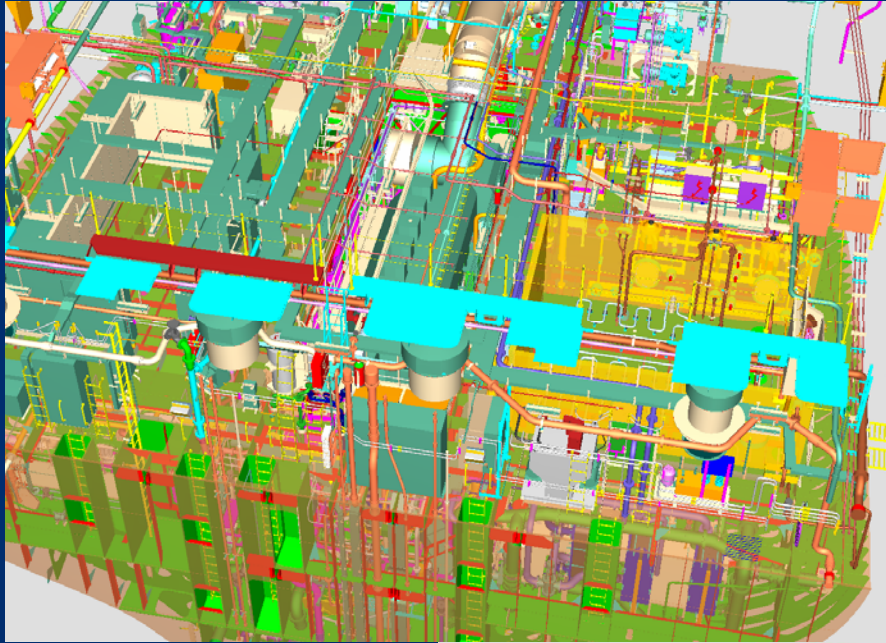

Subcontractors of Damen Shipyards Galati

Electrical works:

EEKELS

RETEC

ALEWIJNSE

Carpentry works:

HELMERS

KRANENDONK & HERTEL

HVAC works:

HEINEN & HOPMAN

DE HAAN

Blasting and painting works:

DEN BREEJEN

METACOM

Energetic fluids:

LINDE

Engineering works:

MEGA

Quality control:

DAMEN SERVICES

Steel works:

GREEN YARD

CARSINAV and others

Deliveries

A. Total deliveries (since establishment - 1893)	1,151
B. Deliveries (since 1999)	211
Cargo Vessels	71
Tugs and Workboats	56
Others	84

Launching



Launching



Safety Chemical Oil Tanker of 8,150 dwt.

Launching



Launching



Recently delivered
&
Currently under construction

Platform Supply Vessel



Hopper Dredger 700 m³



Heavy Lift Vessel 2 x 800 Tones



Buoy Laying Vessel



River Liner 1145 Car Carrier



Research Vessel



Double Ended RoRo Ferry



Double Hull Oil Tanker 4,500 dwt.



Combi Feeder 800 TEU



Combi Freighter 10,500 dwt.



Safety Chemical Oil Tanker 8,150 dwt.



Tugs & Workboats



Tugs & Workboats



Tugs & Workboats



Tugs & Workboats



Naval Vessels

Landing Platform Dock



Naval Vessels

Hydrographic Survey Vessel



Naval Vessels

Logistic Support Vessel



Thank you for your attention!

